



International Conference on “Public Library Development Trends in the Digital Era”

October 24 to 26, 2012



Staff Capability Training

**Marcellus Turner, city librarian
The Seattle Public Library**

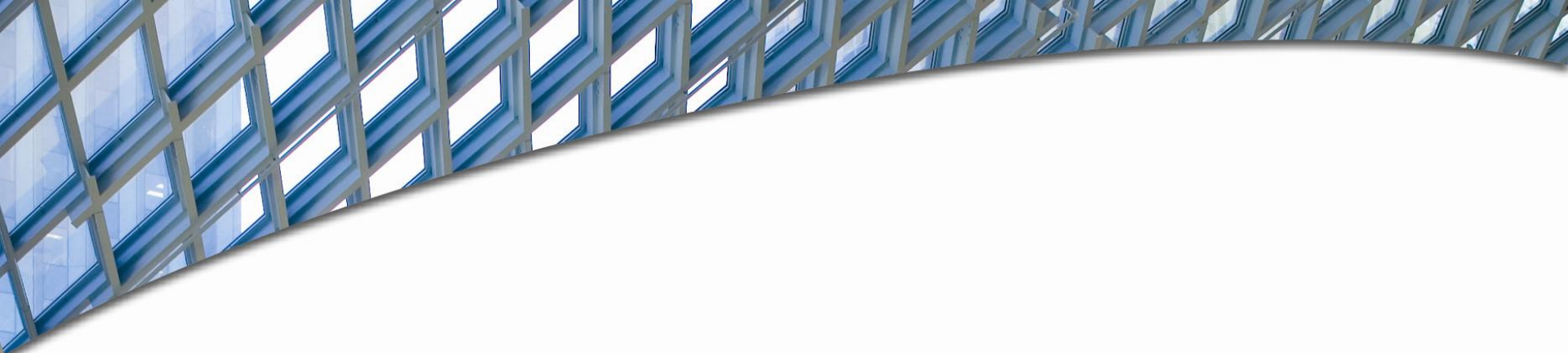

The Seattle Public Library

City's Population: 620,778

Library established: 1890

Number of Libraries: 27 locations plus Mobile Services

Staff Population: 613 (FTE)

Librarians: 127*

- 110 Librarians, Senior Librarians and Selection Services Librarians
- 1 Systems Librarian
- 16 Managing Librarians
- 6 Temporary Librarians*

2011 Circulation: 11,572,778 items

2011 Visits: 14.3 million (6.7 in-person, 7.6 virtual)

2011 Collection size: 2,403,693



The Central Library



- Third library built on this location.
- Construction began in 2001
- Grand opening was May 23, 2004
- Program area 362,987 sq. ft.
- Capacity for 1.45 million items
- More than 400 public computers

The Central Library

This is the third Central Library to be built on this spot.



The Living Room



Living Room

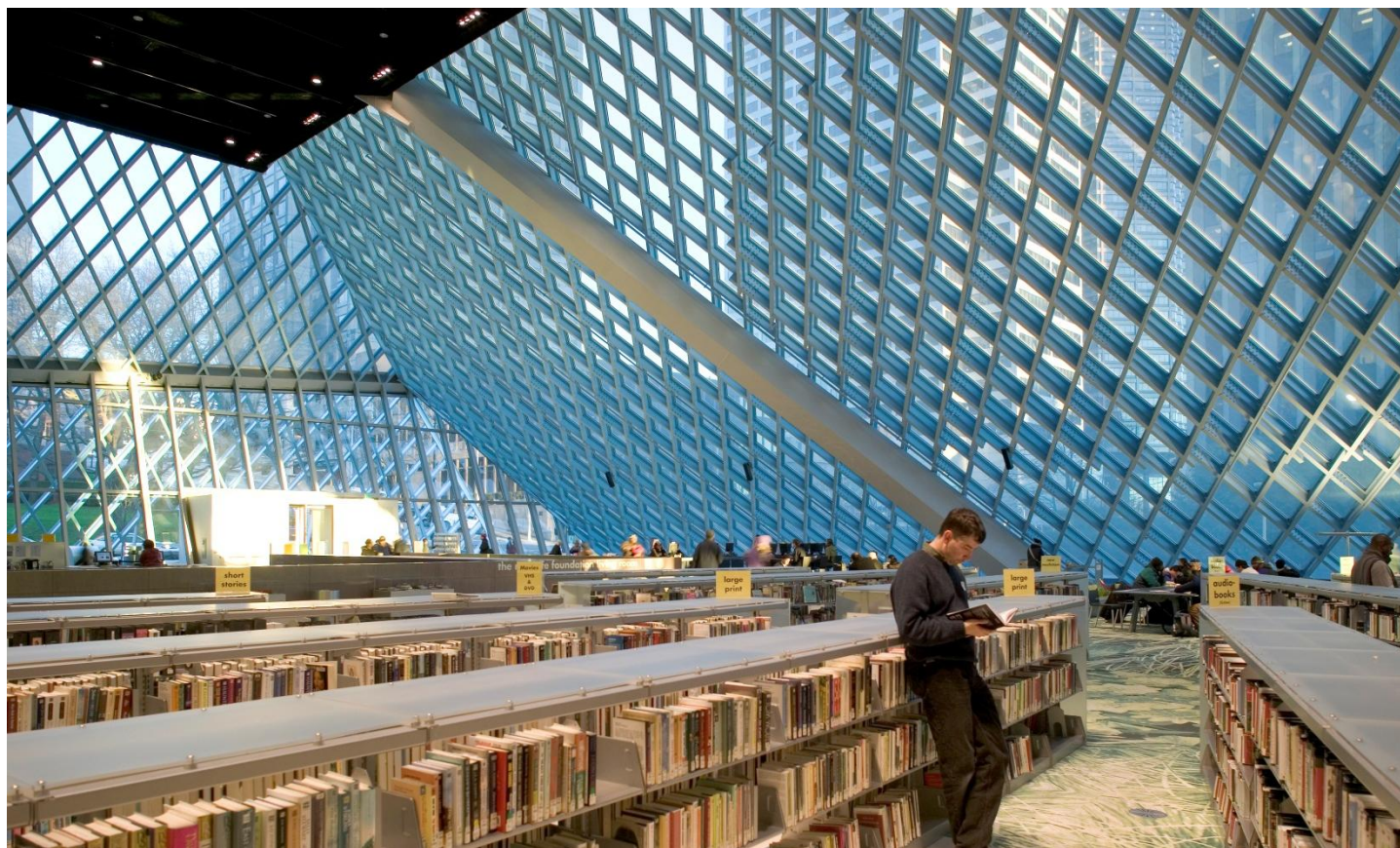

Living Room

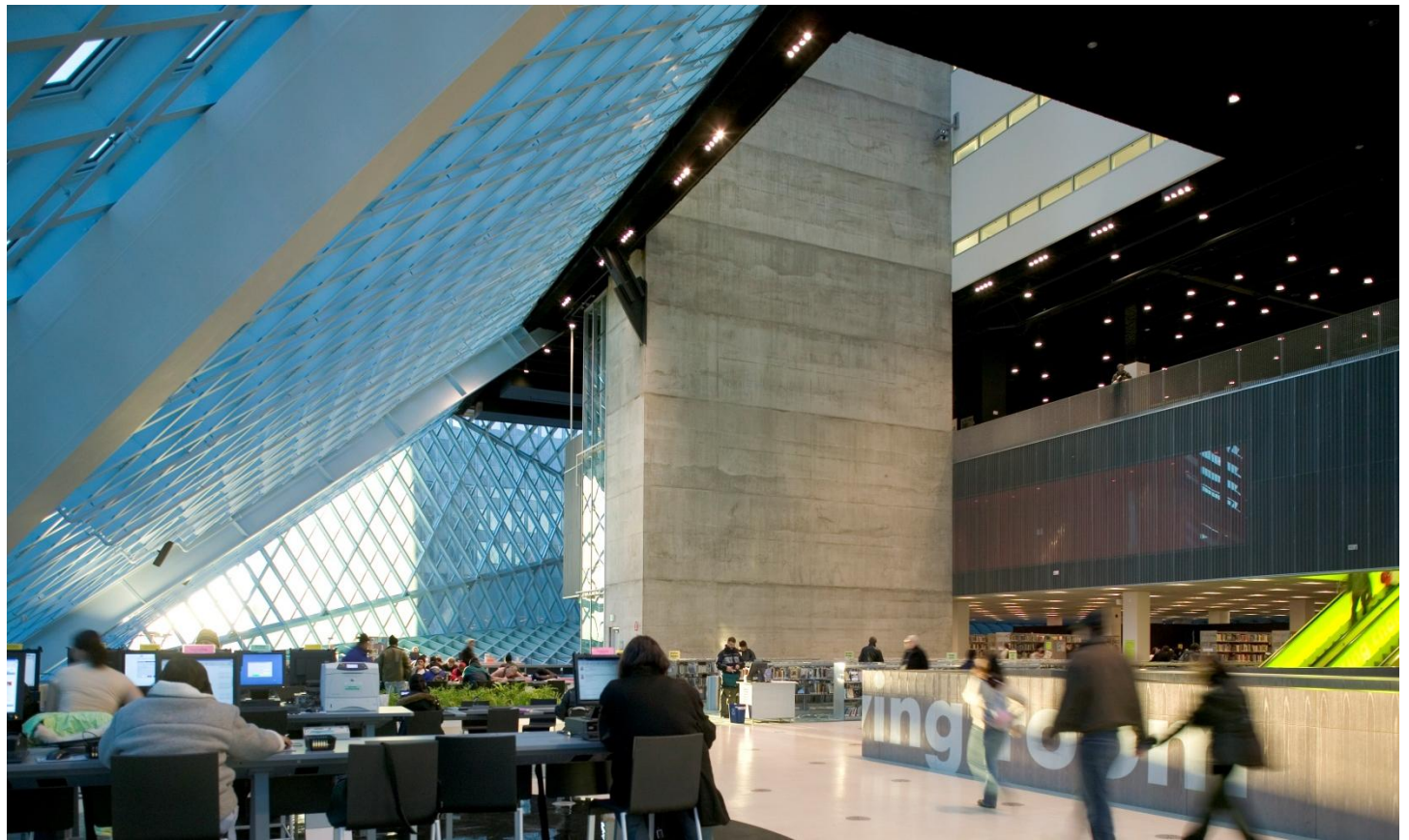

Children's Center

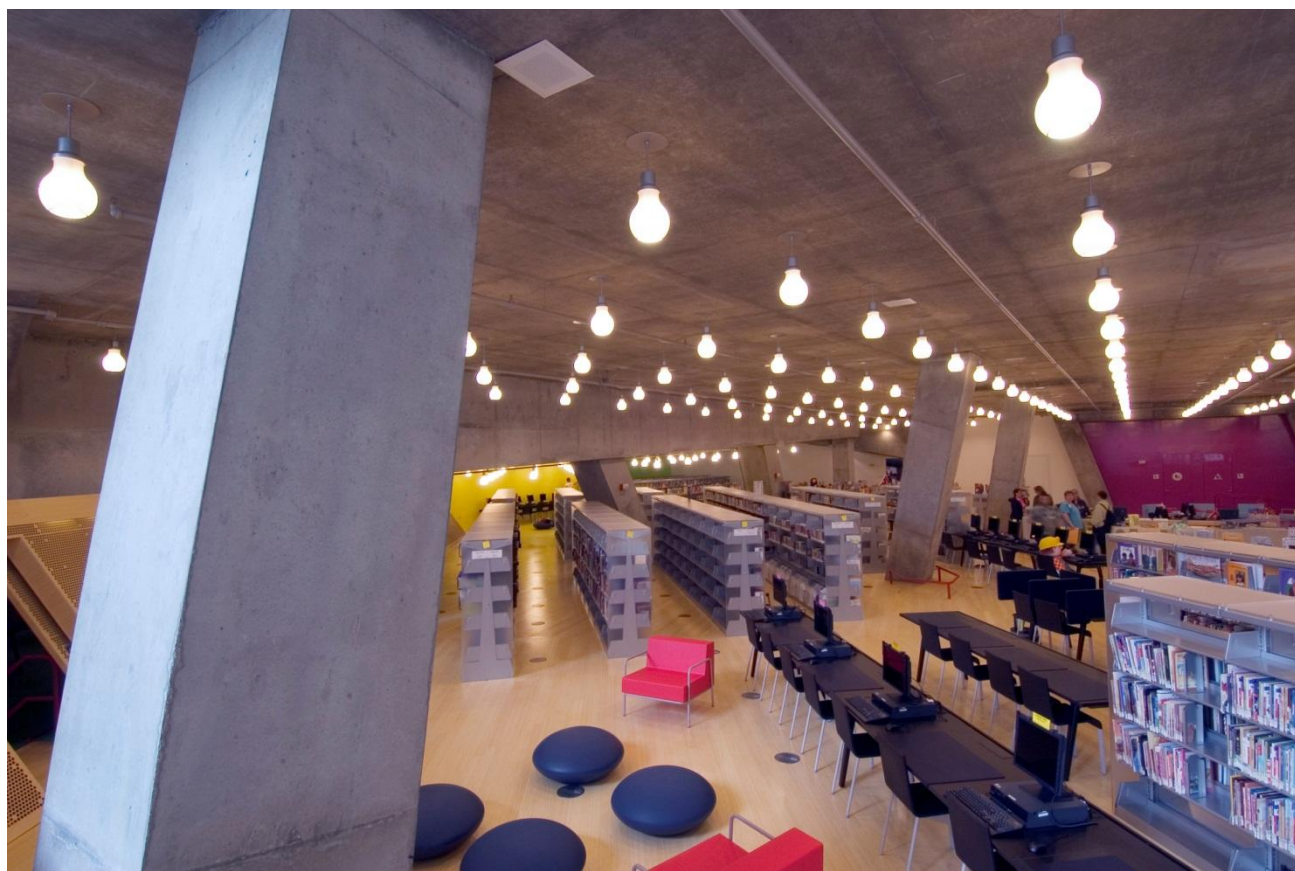

Children's Center



Teen Center



Mixing Chamber Desk



Mixing Chamber

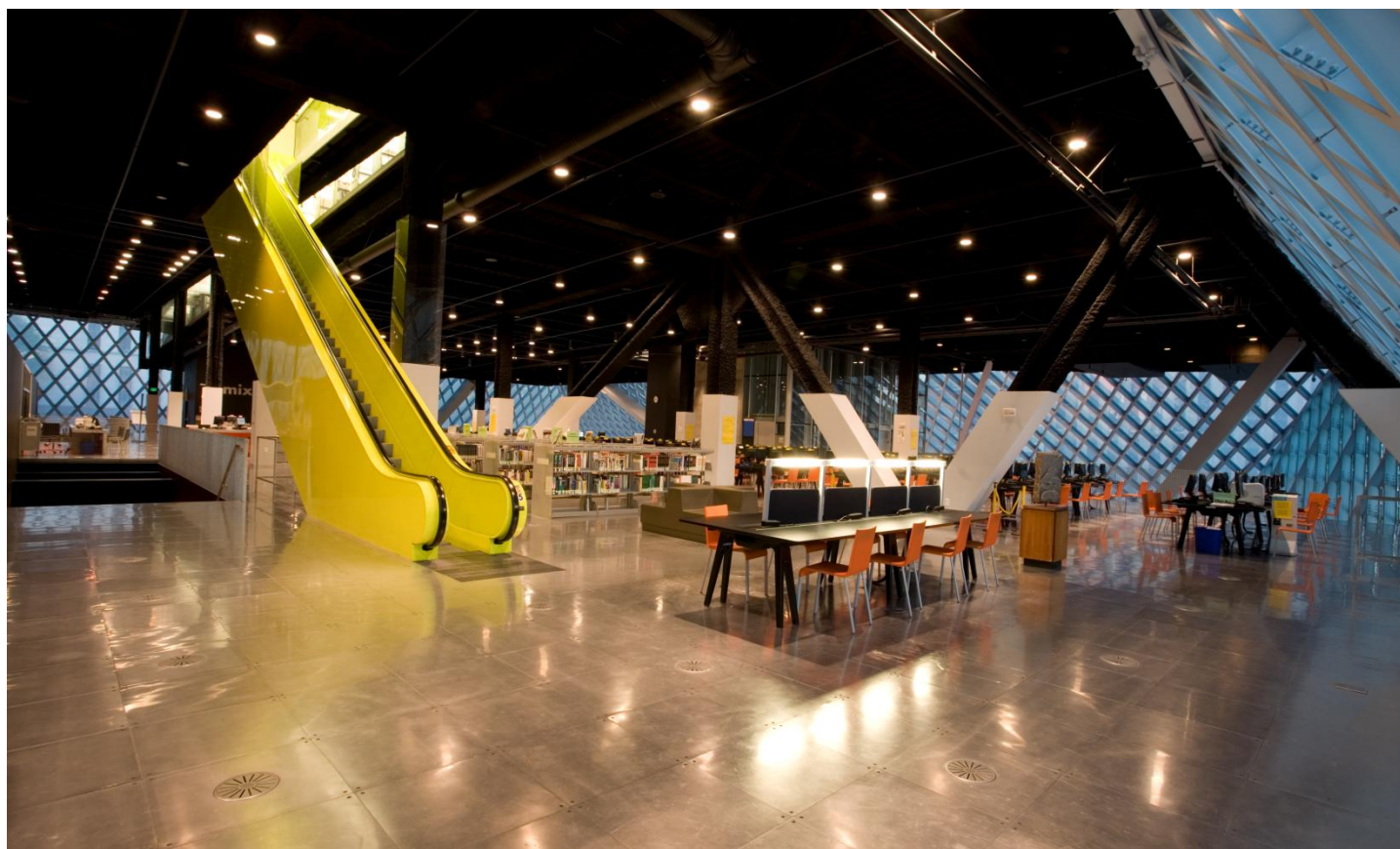

Mixing Chamber



Books Spiral



Books Spiral



Books Spiral



Reading Room

 The
Seattle
Public
Library



Reading Room





Level 4: Meeting Rooms

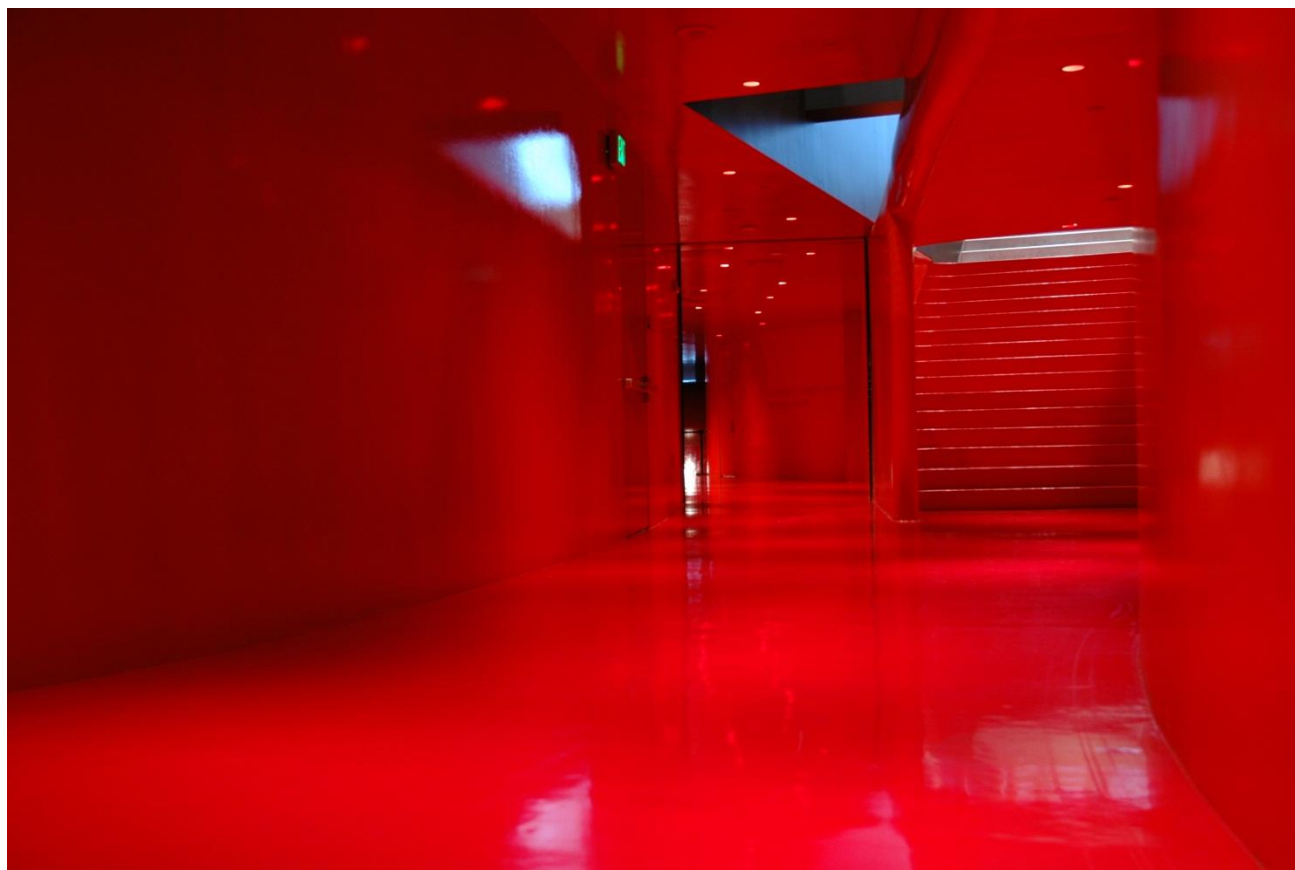

Living Room viewed from Level 4

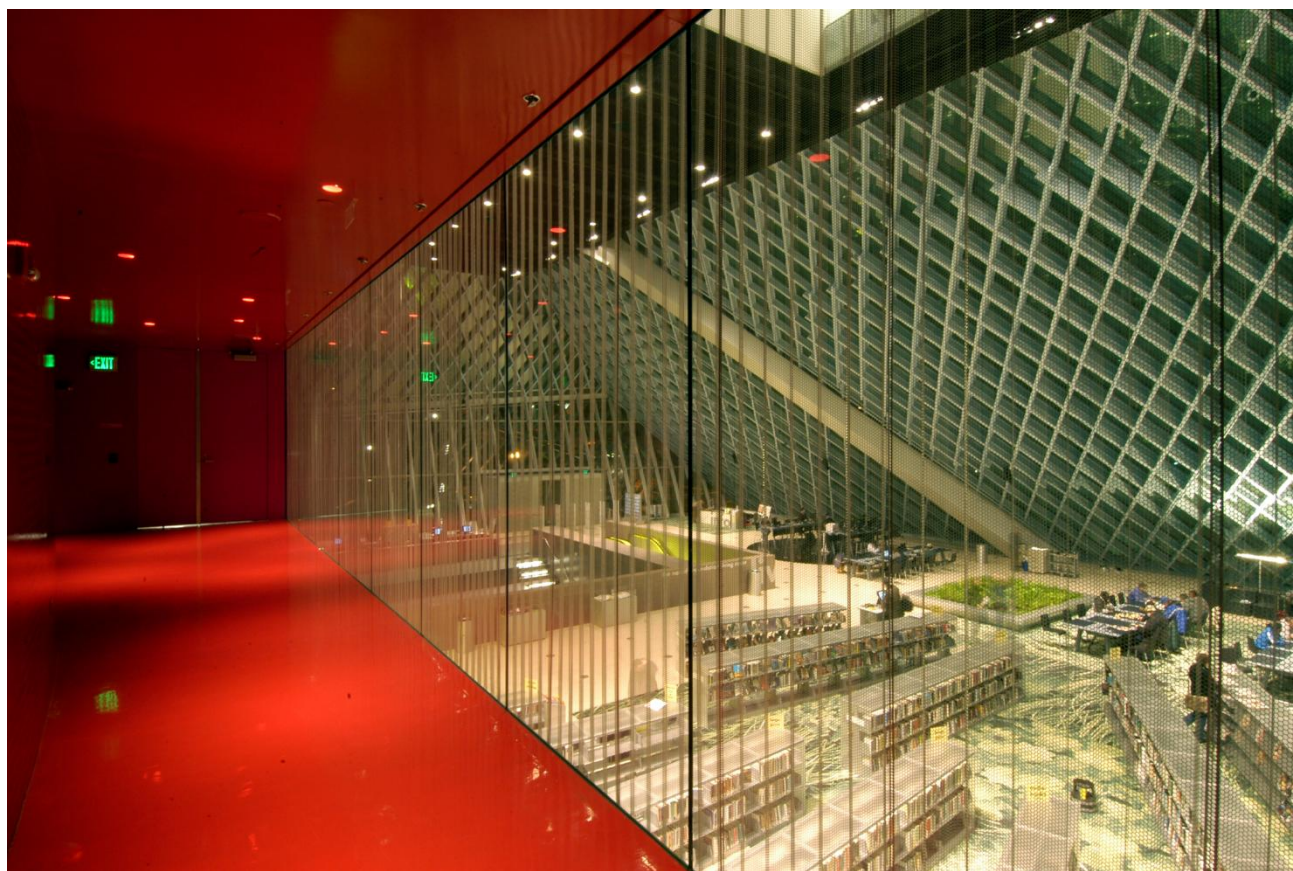

Computer Lab



The Seattle Room





Marcellus Turner

city.librarian@spl.org